

GEWINDELEHRDORNE – THREAD PLUG GAUGES



MESSTECHNIK – METROLOGY



PRODUKTION – PRODUCTION



< 2.74 mm



EINSATZ

Der erste unvollständige Gewindegang und die Frontfläche der Lehre sind hochpräzise und passgenau geschliffen – eine entscheidende Voraussetzung für korrekte Messergebnisse und die Überprüfung der Gewinde auf einer grösstmöglichen Länge.



PROFILKONTROLLE

Dank unserer Kompetenz auf dem Gebiet des Schleifens können wir die perfekte Einhaltung der Toleranzen des Gewindeprofils und eine einwandfreie Oberflächenqualität gewährleisten.



NO-GO-GEWINDELEHRRING

Unsere NO-GO-Lehrringe gewährleisten eine exakte Kontrolle der Gewindeflanken von Schrauben: ihr freigestochener Aussendurchmesser verhindert Fehlmessungen durch blockierende Schrauben am Aussendurchmesser während des Prüfungsvorgangs.



MODULARES SYSTEM

Bei Bedarf kann die GO-Gewindelehre mit einem Verbindungsstück mit der NO-GO-Lehre zusammengeschraubt werden. In ihrer stabilen Verpackung lassen sich die Lehren sicher transportieren. Der mit Aussparungen versehene Schaumstoffeinsatz schützt die Werkzeuge vor Beschädigungen und Schmutz.

PRÜF-GEWINDELEHRDORNE — PLUG CHECK GAUGES

Der **NO-GO**-Prüf-Gewindelehrdorn dient zur Kontrolle des neuwertigen Lehrings.

The **NO-GO** plug check gauge is the foolproofing device for the new ring gauge.

Mit dem **GO**-Prüf-Gewindelehrdorn überprüfen Sie die Qualität Ihres Lehrings.

The **GO** plug check gauge is used to check the quality of your ring gauge.

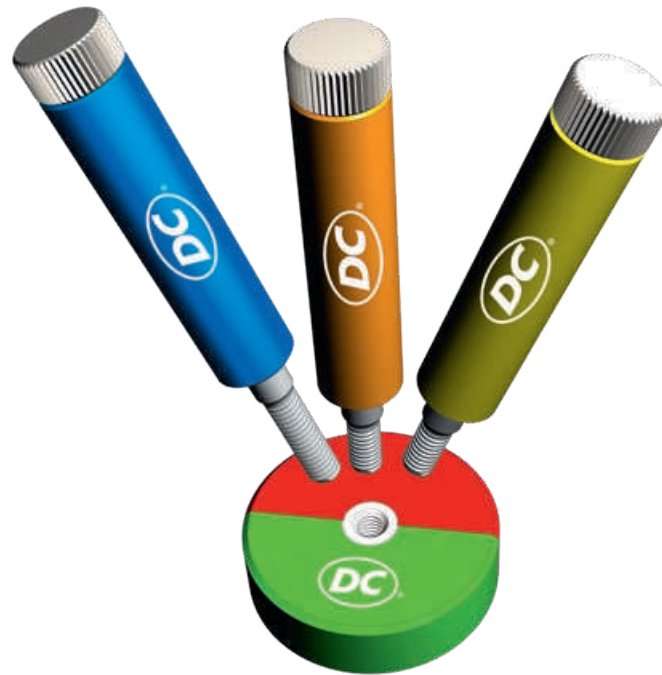

Der Verschleisslehrdorn **WEAR** verlängert die Lebensdauer Ihres Lehrings bis zu einem festgelegten Schwellenwert.

The master plug gauge **WEAR** will extend the service life of your ring gauge up to a certain tolerance limit.

UTILISATION

The fact that the initial turn of the screw thread and also the tip of the gauge have been ground flat ensures that the tool engages optimally in the thread, which is essential for ensuring a correct measurement. This enables the gauge to check the thread at its maximum depth.

PROFILE CONTROL

Our expertise in the field of rectification ensures we have perfect control of tolerances for the shape of the profile and for surface textures.

NO-GO RING GAUGE

The cut-away on the exterior diameter of our NO-GO ring gauges ensures the sides of the screw can be optimally checked, eliminating the risk of any incorrect inspection caused by a blockage on the exterior diameter of the gauge.

MODULAR SYSTEM

A coupling screw enables the GO gauge to be connected to the NO-GO section as required. The rigid box protects the gauges during transportation. Its moulded interior keeps the product clean and protects it from impacts.

DAS SCS-ZERTIFIKAT



Ein Zertifikat ist ein schriftlicher Nachweis über die Qualität der im Unternehmen eingesetzten Messinstrumente. DC NANO TOOLS SA (Akkreditierung SCS 0143), ein Mitglied der DC SWISS Holding, bietet Ihnen die Prüfung und Kalibrierung Ihrer Gewindelehren nach der internationalen Norm ISO 17025 an.

Diese kostenpflichtige Dienstleistung wird für Flankendurchmesser von 0.1 bis 3.0 mm und für Aussendurchmesser von 0.1 bis 3.5 mm angeboten.

Alle Lehrdorne sind SCS-zertifiziert.

ISO 17025:2017 akkreditiert © DC NANO TOOLS SA

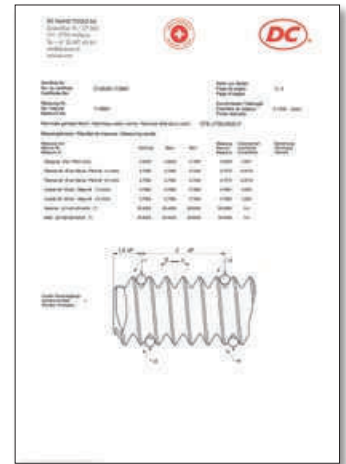
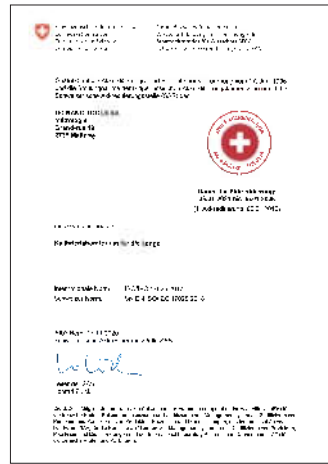

SCS MEASUREMENT CERTIFICATE



A certificate is written confirmation of the quality of a company's metrological equipment. DC NANO TOOLS SA (SCS accreditation 0143), a member of the DC SWISS Group, can inspect and calibrate thread gauges for you in accordance with the ISO 17025 international standard.

This chargeable service is available for pitch diameters of 0.1 to 3.0 mm and external diameters of 0.1 to 3.5 mm.

All plug thread gauges are SCS certified.

ISO 17025:2017 accredited © DC NANO TOOLS SA

SO ERHALTEN SIE IHR KONFORMITÄT SZERTIFIKAT ONLINE

Ab sofort können Sie Ihr Konformitätszertifikat von überall direkt per Smartphone anfordern. Dazu scannen Sie einfach den QR-Code auf der Karte, die der Box beiliegt und laden die PDF-Datei im Anhang herunter.

Der mit jeder Box gelieferte Konformitätsnachweis bestätigt, dass am Ende der Fertigung eine sorgfältige Kontrolle durchgeführt wurde.

Qualitätskontrolle DC SWISS SA

DOWNLOAD YOUR CONFIRMATION OF COMPLIANCE

You can now access your confirmation of compliance any time, at any place on your phone. Simply scan the QR code on the card inside the box and download the associated pdf file.

The confirmation of compliance accompanying each box confirms that the factory has scrupulously followed the post-production monitoring process.

DC SWISS SA quality control

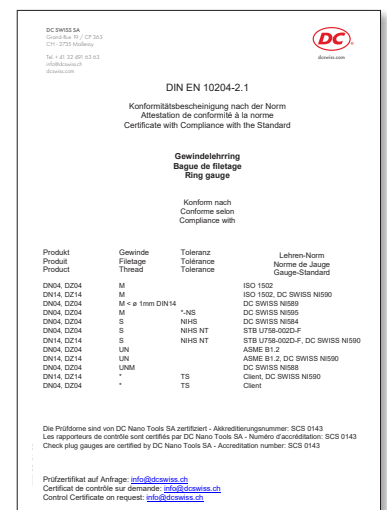



nomu

VERFÜGBARE SETS — AVAILABLE SETS



**GEWINDELEHRDORNE DN / GEWINDELEHRRINGE DN
THREAD PLUG GAUGES & RING GAUGES DN**

EINHEITS-SET — SINGLE SET



**GEWINDELEHRRINGE DZ
THREAD RING GAUGES DZ**

EINHEITS-SET — SINGLE SET



**GEWINDELEHRDORNE DN / GEWINDELEHRRINGE DN
PLUG GAUGES DN / RING GAUGES DN**

**10- ODER 20-TEILIGES SET
SET OF 10 OR 20 ITEMS**

*Für jedes Set können Sie die gewünschte Anzahl
GO / NO-GO-Gewindelehren bestimmen.*

*Wenden Sie sich gerne an uns wenn Sie
eine andere Zusammenstellung wünschen.*

*You can select the exact number of
GO / NO-GO thread gauges for each set.*

Contact us for any other set compositions.

dcswiss.com / info@dcswiss.ch / +41 32 491 63 63

BESTELLUNG NANO-GEWINDELEHREN – NANO THREAD GAUGES ORDER

WERKZEUGTYP – TOOL TYPE







MERKMALE – CHARACTERISTICS

| ABMESSUNG DIMENSION | TOLERANZ TOLERANCE | NORM NORM | MENGE QUANTITY | SPEZIELLES SPECIFICS |
|------------------------|-----------------------|--------------|-------------------|-------------------------|
| | | | | |
| | | | | |
| | | | | |
| | | | | |
| | | | | |
| | | | | |



BEMERKUNGEN – REMARKS

LIEFERINFORMATIONEN – DELIVERY INFORMATION







Bitte visieren Sie Ihre Bestellung.
Thank you for initialing your order.



| | Gewindelehrdorne Thread plug gauges | | | Gewindelehrringe Thread ring gauges | | | | Prüf-Gewindelehrdorne Plug check gauges | | | |
|-----------------------------|--|------------|---------------|--|---------------|------------|---------------|--|--------------|-----------------|-----------------|
| Merkmale Characteristics | | | | | | | | | | | |
| Typ Type | DN01 GO | DN01 GO | DN02 NO-GO | DZ04 GO | DZ14 NO-GO | DN04 GO | DN14 NO-GO | RN05-1 GO | RN15-1 GO | RN05-2 NO-GO | RN15-2 NO-GO |
| M 4H / 5h | ISO DIN 14 | | | | | | | | | | |
| | ISO DIN 13 | | | | | | | | | | |
| M 6H / 6g | ISO DIN 13 | | | | | | | | | | |
| M 5H / 6h | ISO DIN 13 | | | | | | | | | | |
| MF 4H / 4h | ISO DIN 13 | | | | | | | | | | |
| MF 6H / 6g | ISO DIN 13 | | | | | | | | | | |
| MF 6h | ISO DIN 13 | | | | | | | | | | |
| UNC 2B / 2A | ASME B1.1 | | | | | | | | | | |
| UNC 3B / 3A | ASME B1.1 | | | | | | | | | | |
| UNF 2B / 2A | ASME B1.1 | | | | | | | | | | |
| UNF 3B / 3A | ASME B1.1 | | | | | | | | | | |
| S NIHS 3G | NIHS | | | | | | | | | | |
| S NIHS 4H | NIHS | | | | | | | | | | |
| S NIHS 4H / 3G | NIHS | | | | | | | | | | |
| S NIHS | NIHS | | | | | | | | | | |
| S NIHS NT | NIHS | | | | | | | | | | |
| SF NIHS 3G | NIHS | | | | | | | | | | |
| SF NIHS 4H | NIHS | | | | | | | | | | |
| SF NIHS 4H / 3G | NIHS | | | | | | | | | | |
| SF NIHS | NIHS | | | | | | | | | | |
| SF NIHS NT | NIHS | | | | | | | | | | |
| SL | SL 15-01 | | | | | | | | | | |

| | Abnutzungsprüfdorne Master plug gauges WEAR | Kalibrier-Gewindelehndorne Calibration thread plug gauges |
|---|---|---|
| Merkmale Characteristics | | |
| |  |  |
| Typ Type | RN05-3 WEAR | RN15-3 WEAR |
| M 4H / 5h ISO DIN 14 ISO DIN 13 | | EN00 |
| M 6H / 6g ISO DIN 14 ISO DIN 13 | 401 | 401 |
| M 5H / 6h ISO DIN 13 | 401 | 401 |
| MF 4H / 4h ISO DIN 13 | 404 | 404 |
| MF 6H / 6g ISO DIN 13 | 404 | 404 |
| MF 6h ISO DIN 13 | 404 | 404 |
| S NIHS NIHS | | 411 |

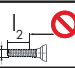
Piktogramme - Pictographs

-  "Gut"
"Go"
-  "Ausschuss"
"No-Go"
-  Toleranz 6H, "Gut"
Tolerance 6H, "Go"
-  Toleranz 6g, "Ausschuss"
Tolerance 6g, "No-Go"
-  Max. Messlänge l2 darf nicht überschritten werden
Max. measuring length l2 must not be exceeded
-  **PHYN. KL** Phynox KL
Phynox KL
-  **LH** Alle Gewindelehren sind auf Anfrage auch für Linksgewinde lieferbar
All gauges can be supplied with a left-hand thread upon request

Einsatz — Use

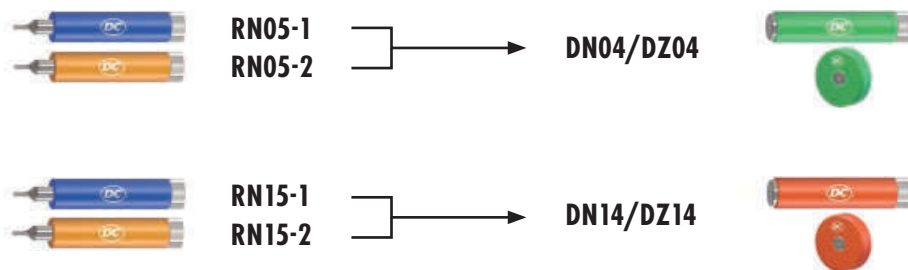

nano

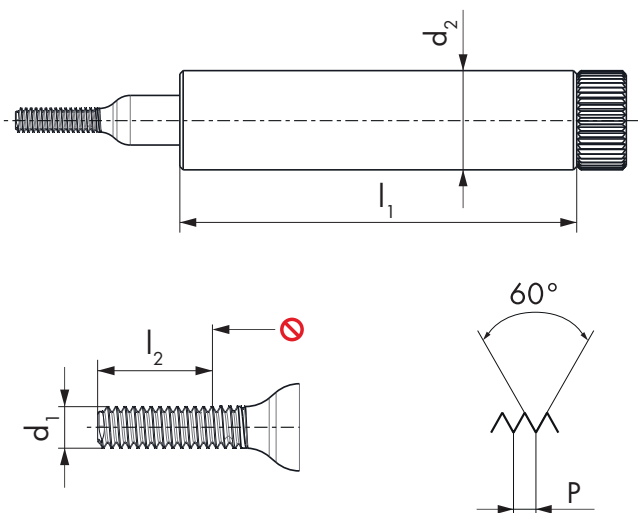

DN01 GO

DN02 NO-GO

DN01 GO

DN02 NO-GO



4H

4H

5H

5H

| $\emptyset d_1$ M | P mm | l_1 mm | l_2 GO mm | d_2 mm | ID | ID | ID | ID |
|----------------------|---------|-------------|----------------|-------------|----------|----------|----------|----------|
| 0.3 | 0.08 | 24 | 0.9 | 6 | ● 192778 | ● 192786 | | |
| 0.35 | 0.09 | 24 | 1.05 | 6 | ● 192779 | ● 192787 | | |
| 0.4 | 0.1 | 24 | 1.2 | 6 | ● 192780 | ● 192788 | | |
| 0.5 | 0.125 | 24 | 1.5 | 6 | ● 192781 | ● 192789 | | |
| 0.6 | 0.15 | 24 | 1.8 | 6 | ● 192782 | ● 192790 | | |
| 0.7 | 0.175 | 24 | 2.1 | 6 | ● 192783 | ● 192791 | | |
| 0.8 | 0.2 | 24 | 2.4 | 6 | ● 192784 | ● 192792 | | |
| 0.9 | 0.225 | 24 | 2.7 | 6 | ● 192785 | ● 192793 | | |
| 1 | 0.25 | 24 | 3 | 6 | ● 191113 | ● 191127 | ● 191421 | ● 191424 |
| 1.2 | 0.25 | 24 | 3.6 | 6 | ● 191114 | ● 191128 | ● 191422 | ● 191425 |
| 1.4 | 0.3 | 24 | 4.2 | 6 | ● 191115 | ● 191129 | ● 191423 | ● 191426 |

6H

6H

| $\emptyset d_1$ M | P mm | l_1 mm | l_2 GO mm | d_2 mm | ID | ID |
|----------------------|---------|-------------|----------------|-------------|----------|----------|
| 1.6 | 0.35 | 24 | 4.5 | 6 | ● 191427 | ● 191433 |
| 1.8 | 0.35 | 24 | 4.5 | 6 | ● 191428 | ● 191434 |
| 2 | 0.4 | 24 | 4.5 | 6 | ● 191429 | ● 191435 |
| 2.3 | 0.4 | 24 | 4.5 | 6 | ● 191430 | ● 191436 |
| 2.5 | 0.45 | 24 | 4.5 | 6 | ● 191431 | ● 191437 |
| 2.6 | 0.45 | 24 | 4.5 | 6 | ● 191432 | ● 191438 |



All nano thread plug gauges are SCS-certified and the paid certificate is available on request.

nano

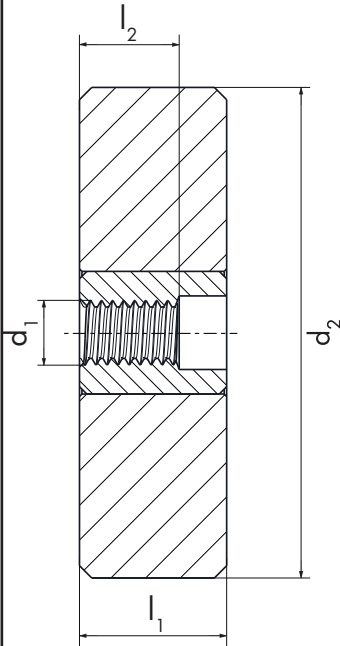

DZ04 GO

DZ14 NO-GO

DZ04 GO

DZ14 NO-GO



5h

5h

6h

6h

| $\emptyset d_1$ M | P mm | l_1 mm | l_2 GO mm | d_2 mm | ID | ID | ID | ID |
|----------------------|---------|-------------|----------------|-------------|----------|----------|----------|----------|
| * 0.3 | 0.08 | 6 | 0.45 | 20 | ● 192842 | ● 192850 | | |
| * 0.35 | 0.09 | 6 | 0.53 | 20 | ● 192843 | ● 192851 | | |
| 0.4 | 0.1 | 6 | 0.6 | 20 | ● 192844 | ● 192852 | | |
| 0.5 | 0.125 | 6 | 0.75 | 20 | ● 192845 | ● 192853 | | |
| 0.6 | 0.15 | 6 | 0.9 | 20 | ● 192846 | ● 192854 | | |
| 0.7 | 0.175 | 6 | 1.05 | 20 | ● 192847 | ● 192855 | | |
| 0.8 | 0.2 | 6 | 1.2 | 20 | ● 192848 | ● 192856 | | |
| 0.9 | 0.225 | 6 | 1.35 | 20 | ● 192849 | ● 192857 | | |
| 1 | 0.25 | 6 | 1.5 | 20 | | | ● 191473 | ● 191476 |
| 1.2 | 0.25 | 6 | 1.8 | 20 | | | ● 191474 | ● 191477 |
| 1.4 | 0.3 | 6 | 2.1 | 20 | | | ● 191475 | ● 191478 |
| * In development | | | | | | | | |

6g

6g

| $\emptyset d_1$ M | P mm | l_1 mm | l_2 GO mm | d_2 mm | ID | ID |
|----------------------|---------|-------------|----------------|-------------|----------|----------|
| 1.6 | 0.35 | 6 | 2.4 | 20 | ● 191479 | ● 191485 |
| 1.8 | 0.35 | 6 | 2.7 | 20 | ● 191480 | ● 191486 |
| 2 | 0.4 | 6 | 3 | 20 | ● 191481 | ● 191487 |
| 2.3 | 0.4 | 6 | 3.45 | 20 | ● 191482 | ● 191488 |
| 2.5 | 0.45 | 6 | 3.75 | 20 | ● 191483 | ● 191489 |
| 2.6 | 0.45 | 6 | 3.9 | 20 | ● 191484 | ● 191490 |



All nano ring gauges have a certificate of measurement, established with SCS certified plug check gauges. The paid certificate is available on request.



nano

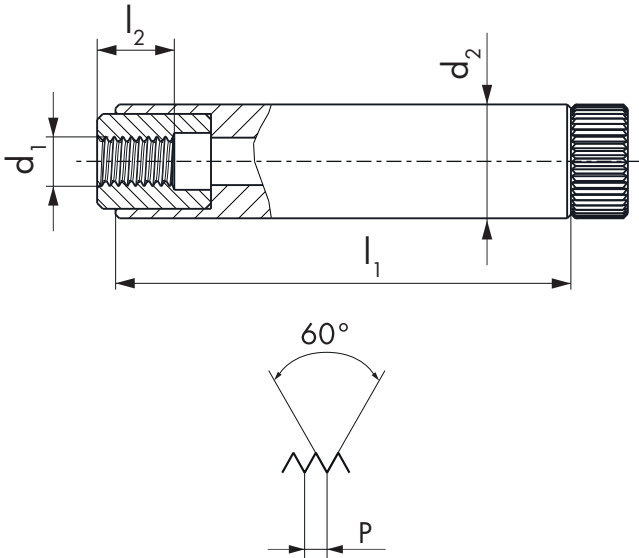

DN04 GO DN14 NO-GO DN04 GO DN14 NO-GO



| $\emptyset d_1$ M | P mm | l_1 mm | l_2 GO mm | d_2 mm | ID | ID | ID | ID |
|----------------------|---------|-------------|----------------|-------------|----------|----------|----------|----------|
| * 0.3 | 0.08 | 24 | 0.45 | 6 | ● 192800 | ● 192808 | | |
| * 0.35 | 0.09 | 24 | 0.53 | 6 | ● 192801 | ● 192809 | | |
| 0.4 | 0.1 | 24 | 0.6 | 6 | ● 192802 | ● 192810 | | |
| 0.5 | 0.125 | 24 | 0.75 | 6 | ● 192803 | ● 192811 | | |
| 0.6 | 0.15 | 24 | 0.9 | 6 | ● 192804 | ● 192812 | | |
| 0.7 | 0.175 | 24 | 1.05 | 6 | ● 192805 | ● 192813 | | |
| 0.8 | 0.2 | 24 | 1.2 | 6 | ● 192806 | ● 192814 | | |
| 0.9 | 0.225 | 24 | 1.35 | 6 | ● 192807 | ● 192815 | | |
| 1 | 0.25 | 24 | 1.5 | 6 | | | ● 191447 | ● 191450 |
| 1.2 | 0.25 | 24 | 1.8 | 6 | | | ● 191448 | ● 191451 |
| 1.4 | 0.3 | 24 | 2.1 | 6 | | | ● 191449 | ● 191452 |
| * In development | | | | | | | | |



| $\emptyset d_1$ M | P mm | l_1 mm | l_2 GO mm | d_2 mm | ID | ID |
|----------------------|---------|-------------|----------------|-------------|----------|----------|
| 1.6 | 0.35 | 24 | 2.4 | 6 | ● 191453 | ● 191459 |
| 1.8 | 0.35 | 24 | 2.7 | 6 | ● 191454 | ● 191460 |
| 2 | 0.4 | 24 | 3 | 6 | ● 191455 | ● 191461 |
| 2.3 | 0.4 | 24 | 3.45 | 6 | ● 191456 | ● 191462 |
| 2.5 | 0.45 | 24 | 3.75 | 6 | ● 191457 | ● 191463 |
| 2.6 | 0.45 | 24 | 3.9 | 6 | ● 191458 | ● 191464 |



All nano ring gauges have a certificate of measurement, established with SCS certified plug check gauges. The paid certificate is available on request.

nano

DN01 GO

DN02 NO-GO

DN01 GO

DN02 NO-GO

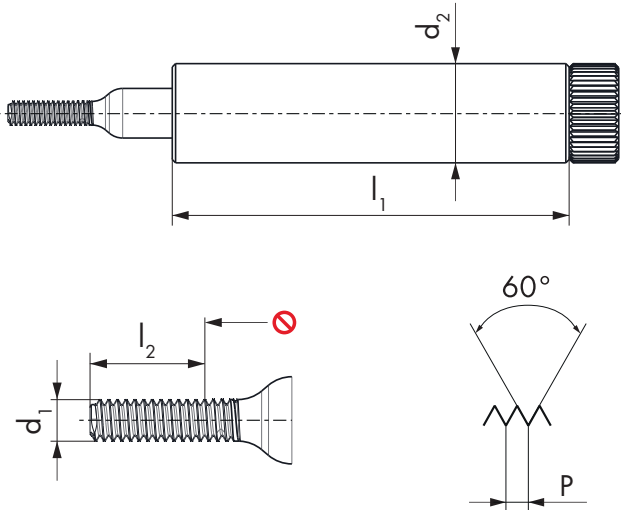

| $\emptyset d_1$ MF | P mm | l_1 mm | l_2 GO mm | d_2 mm | ID | ID | ID | ID |
|-----------------------|---------|-------------|----------------|-------------|----------|----------|----------|----------|
| 1.4 | 0.2 | 24 | 4.2 | 6 | ● 191116 | ● 191130 | | |
| 1.6 | 0.2 | 24 | 3 | 6 | ● 191117 | ● 191131 | | |
| 1.8 | 0.2 | 24 | 3 | 6 | ● 191118 | ● 191132 | | |
| 2 | 0.2 | 24 | 3 | 6 | ● 191119 | ● 191133 | | |
| 2 | 0.25 | 24 | 3 | 6 | ● 192794 | ● 192797 | | |
| 2.2 | 0.2 | 24 | 3 | 6 | ● 191120 | ● 191134 | | |
| 2.2 | 0.25 | 24 | 3 | 6 | ● 191121 | ● 191135 | | |
| 2.3 | 0.2 | 24 | 3 | 6 | ● 191122 | ● 191136 | | |
| 2.3 | 0.25 | 24 | 3 | 6 | ● 191123 | ● 191137 | | |
| 2.5 | 0.2 | 24 | 3 | 6 | ● 191124 | ● 191138 | | |
| 2.5 | 0.25 | 24 | 3 | 6 | ● 191125 | ● 191139 | | |
| 2.5 | 0.35 | 24 | 4.5 | 6 | | | ● 192795 | ● 192798 |
| 2.6 | 0.35 | 24 | 4.5 | 6 | | | ● 192796 | ● 192799 |

nano



All nano thread plug gauges are SCS-certified and the paid certificate is available on request.

nano

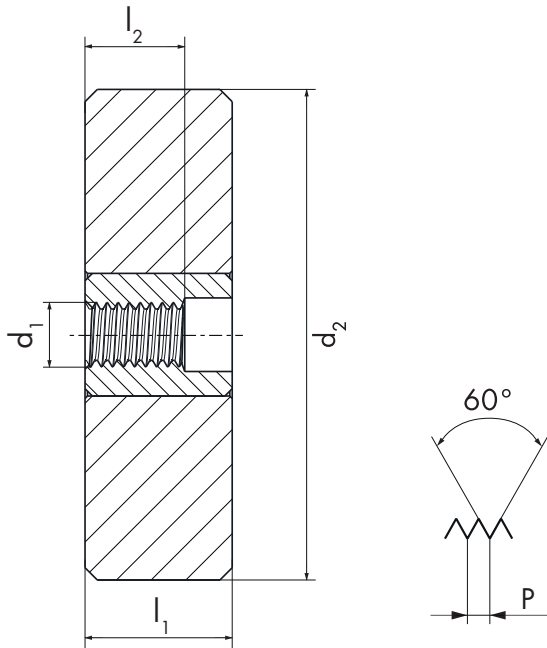

DZ04 GO

DZ14 NO-GO

DZ04 GO

DZ14 NO-GO



4h

4h

6g

6g

| $\emptyset d_1$ MF | P mm | l_1 mm | l_2 GO mm | d_2 mm | ID | ID | ID | ID |
|-----------------------|---------|-------------|----------------|-------------|----------|----------|-----------------------|-----------------------|
| 1.4 | 0.2 | 6 | 2.1 | 20 | ● 194887 | ● 194888 | ● 192858 ¹ | ● 192871 ¹ |
| 1.6 | 0.2 | 6 | 1.8 | 20 | ● 191201 | ● 191215 | ● 191229 | ● 191243 |
| 1.8 | 0.2 | 6 | 1.8 | 20 | ● 191202 | ● 191216 | ● 191230 | ● 191244 |
| 2 | 0.2 | 6 | 1.8 | 20 | ● 190711 | ● 190710 | ● 191231 | ● 191245 |
| 2 | 0.25 | 6 | 2.25 | 20 | ● 194872 | ● 190690 | ● 194876 | ● 194877 |
| 2.2 | 0.2 | 6 | 1.8 | 20 | ● 191204 | ● 191218 | ● 191232 | ● 191246 |
| 2.2 | 0.25 | 6 | 2.25 | 20 | ● 191205 | ● 191219 | ● 191233 | ● 191247 |
| 2.3 | 0.2 | 6 | 1.8 | 20 | ● 191206 | ● 191220 | ● 191234 | ● 191248 |
| 2.3 | 0.25 | 6 | 2.25 | 20 | ● 191207 | ● 191221 | ● 191235 | ● 191249 |
| 2.5 | 0.2 | 6 | 1.8 | 20 | ● 191208 | ● 191222 | ● 191236 | ● 191250 |
| 2.5 | 0.25 | 6 | 2.25 | 20 | ● 194873 | ● 191223 | ● 191237 | ● 191251 |
| 2.5 | 0.35 | 6 | 3.75 | 20 | | | ● 192869 | ● 192882 |
| 2.6 | 0.35 | 6 | 3.9 | 20 | | | ● 192870 | ● 192883 |

¹ Tol. 6h



All nano ring gauges have a certificate of measurement, established with SCS certified plug check gauges. The paid certificate is available on request.

nano

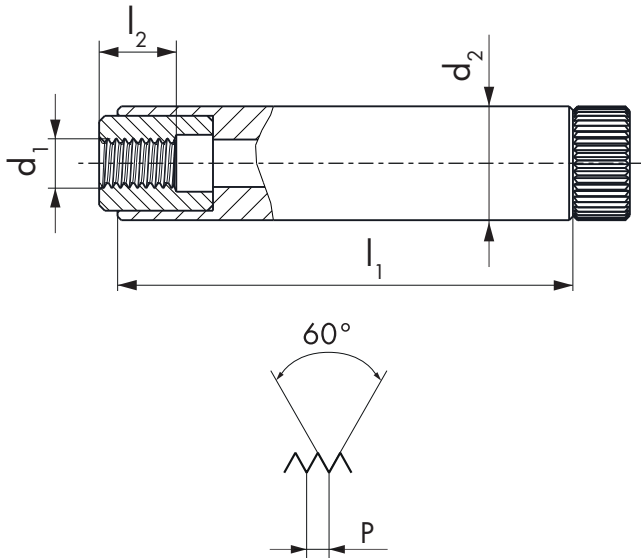

DN04 GO

DN14 NO-GO

DN04 GO

DN14 NO-GO



| $\emptyset d_1$ MF | P mm | l_1 mm | l_2 GO mm | d_2 mm | ID | ID | ID | ID |
|-----------------------|---------|-------------|----------------|-------------|----------|----------|-----------------------|-----------------------|
| 1.4 | 0.2 | 24 | 2.1 | 6 | ● 194885 | ● 194886 | ● 192816 ¹ | ● 192829 ¹ |
| 1.6 | 0.2 | 24 | 1.8 | 6 | ● 191145 | ● 191159 | ● 191173 | ● 191187 |
| 1.8 | 0.2 | 24 | 1.8 | 6 | ● 191146 | ● 191160 | ● 191174 | ● 191188 |
| 2 | 0.2 | 24 | 1.8 | 6 | ● 191147 | ● 191161 | ● 191175 | ● 191189 |
| 2 | 0.25 | 24 | 2.25 | 6 | ● 194870 | ● 194871 | ● 194874 | ● 194875 |
| 2.2 | 0.2 | 24 | 1.8 | 6 | ● 191148 | ● 191162 | ● 191176 | ● 191190 |
| 2.2 | 0.25 | 24 | 2.25 | 6 | ● 191149 | ● 191163 | ● 191177 | ● 191191 |
| 2.3 | 0.2 | 24 | 1.8 | 6 | ● 191150 | ● 191164 | ● 191178 | ● 191192 |
| 2.3 | 0.25 | 24 | 2.25 | 6 | ● 191151 | ● 191165 | ● 191179 | ● 191193 |
| 2.5 | 0.2 | 24 | 1.8 | 6 | ● 191152 | ● 191166 | ● 191180 | ● 191194 |
| 2.5 | 0.25 | 24 | 2.25 | 6 | ● 191153 | ● 191167 | ● 191181 | ● 191195 |
| 2.5 | 0.35 | 24 | 3.75 | 6 | | | ● 192827 | ● 192840 |
| 2.6 | 0.35 | 24 | 3.9 | 6 | | | ● 192828 | ● 192841 |

¹ Tol. 6h



All nano ring gauges have a certificate of measurement, established with SCS certified plug check gauges. The paid certificate is available on request.

UNC, UNF ASME B1.1 ASME B1.2

VHM
CAR

nano

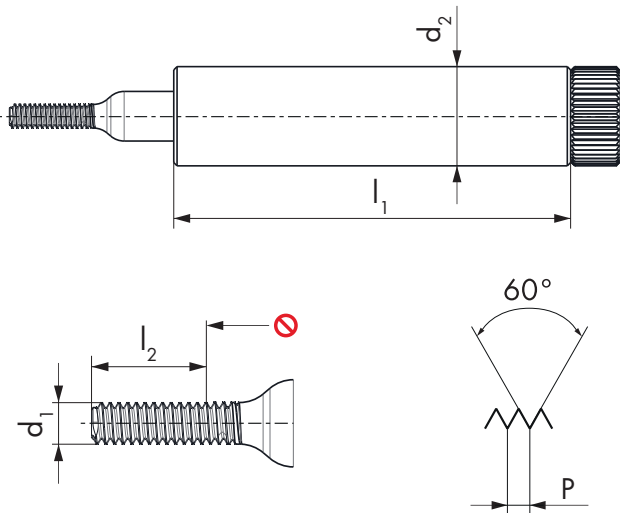

DN01 GO

DN02 NO-GO

DN01 GO

DN02 NO-GO



2B

2B

3B

3B

| $\emptyset d_1$ UNC | P TPI | $\emptyset d_1$ mm | l_1 mm | l_2 GO mm | d_2 mm | ID | ID | ID | ID |
|------------------------|----------|-----------------------|-------------|----------------|-------------|----------|----------|----------|----------|
| 1 | 64 | 1.854 | 24 | 6.35 | 6 | ● 191577 | ● 191580 | ● 191583 | ● 191586 |
| 2 | 54 | 2.184 | 24 | 6.35 | 6 | ● 191578 | ● 191581 | ● 191584 | ● 191587 |
| 3 | 48 | 2.515 | 24 | 6.35 | 6 | ● 191579 | ● 191582 | ● 191585 | ● 191588 |
| $\emptyset d_1$ UNF | P TPI | $\emptyset d_1$ mm | l_1 mm | l_2 GO mm | d_2 mm | ID | ID | ID | ID |
| 0 | 80 | 1.524 | 24 | 4.76 | 6 | ● 191637 | ● 191641 | ● 191645 | ● 191649 |
| 1 | 72 | 1.854 | 24 | 4.76 | 6 | ● 191638 | ● 191642 | ● 191646 | ● 191650 |
| 2 | 64 | 2.184 | 24 | 4.76 | 6 | ● 191639 | ● 191643 | ● 191647 | ● 191651 |
| 3 | 56 | 2.515 | 24 | 4.76 | 6 | ● 191640 | ● 191644 | ● 191648 | ● 191652 |



All nano thread plug gauges are SCS-certified and the paid certificate is available on request.

UNC, UNF

ASME B1.1

DZ04: ASME B1.2 / DZ14: ASME B1.2, DC SWISS NI590

PHYN.
KL

nano

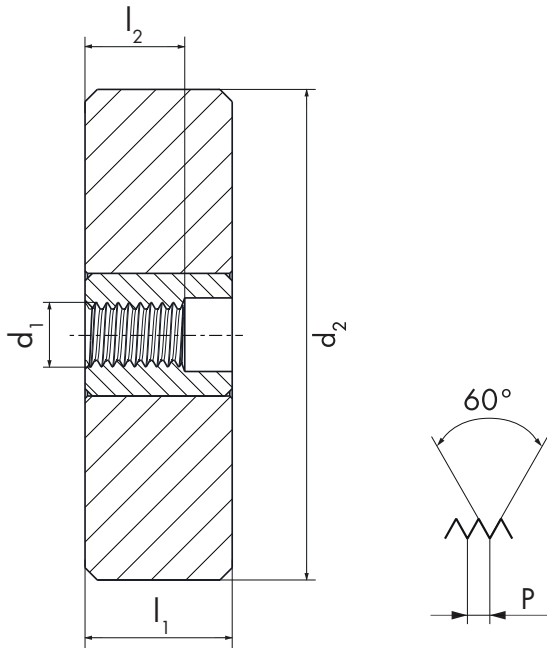

DZ04 GO

DZ14 NO-GO

DZ04 GO

DZ14 NO-GO



2A

2A

3A

3A

| $\emptyset d_1$ UNC | P TPI | $\emptyset d_1$ mm | l_1 mm | l_2 GO mm | d_2 mm | ID | ID | ID | ID |
|------------------------|----------|-----------------------|-------------|----------------|-------------|----------|----------|----------|----------|
| 1 | 64 | 1.854 | 6 | 2.78 | 20 | ● 191601 | ● 191604 | ● 191607 | ● 191610 |
| 2 | 56 | 2.184 | 6 | 3.28 | 20 | ● 191602 | ● 191605 | ● 191608 | ● 191611 |
| 3 | 48 | 2.515 | 6 | 3.77 | 20 | ● 191603 | ● 191606 | ● 191609 | ● 191612 |
| | | | | | | | | | |
| $\emptyset d_1$ UNF | P TPI | $\emptyset d_1$ mm | l_1 mm | l_2 GO mm | d_2 mm | ID | ID | ID | ID |
| 0 | 80 | 1.524 | 6 | 2.29 | 20 | ● 191669 | ● 191673 | ● 191677 | ● 191681 |
| 1 | 72 | 1.854 | 6 | 2.78 | 20 | ● 191670 | ● 191674 | ● 191678 | ● 191682 |
| 2 | 64 | 2.184 | 6 | 3.28 | 20 | ● 191671 | ● 191675 | ● 191679 | ● 191683 |
| 3 | 56 | 2.515 | 6 | 3.77 | 20 | ● 191672 | ● 191676 | ● 191680 | ● 191684 |



All nano ring gauges have a certificate of measurement, established with SCS certified plug check gauges. The paid certificate is available on request.

UNC, UNF

ASME B1.1

DN04: ASME B1.2 / DN14: ASME B1.2, DC SWISS NI590

PHYN.
KL

nano

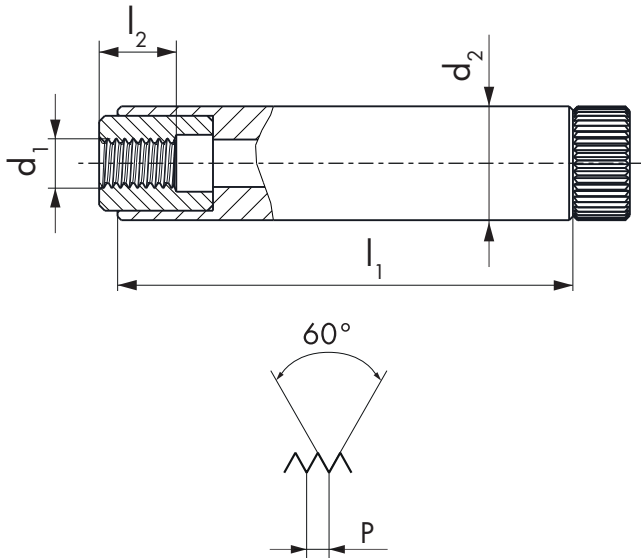

DN04 GO

DN14 NO-GO

DN04 GO

DN14 NO-GO



2A

2A

3A

3A

| $\emptyset d_1$ UNC | P TPI | $\emptyset d_1$ mm | l_1 mm | l_2 GO mm | d_2 mm | ID | ID | ID | ID |
|------------------------|----------|-----------------------|-------------|----------------|-------------|----------|----------|----------|----------|
| 1 | 64 | 1.854 | 24 | 2.78 | 6 | ● 191589 | ● 191592 | ● 191595 | ● 191598 |
| 2 | 56 | 2.184 | 24 | 3.28 | 6 | ● 191590 | ● 191593 | ● 191596 | ● 191599 |
| 3 | 48 | 2.515 | 24 | 3.77 | 6 | ● 191591 | ● 191594 | ● 191597 | ● 191600 |
| | | | | | | | | | |
| $\emptyset d_1$ UNF | P TPI | $\emptyset d_1$ mm | l_1 mm | l_2 GO mm | d_2 mm | ID | ID | ID | ID |
| 0 | 80 | 1.524 | 24 | 2.29 | 6 | ● 191653 | ● 191657 | ● 191661 | ● 191665 |
| 1 | 72 | 1.854 | 24 | 2.78 | 6 | ● 191654 | ● 191658 | ● 191662 | ● 191666 |
| 2 | 64 | 2.184 | 24 | 3.28 | 6 | ● 191655 | ● 191659 | ● 191663 | ● 191667 |
| 3 | 56 | 2.515 | 24 | 3.77 | 6 | ● 191656 | ● 191660 | ● 191664 | ● 191668 |



All nano ring gauges have a certificate of measurement, established with SCS certified plug check gauges. The paid certificate is available on request.

nano

DN01 GO

DN01 GO

DN02 NO-GO

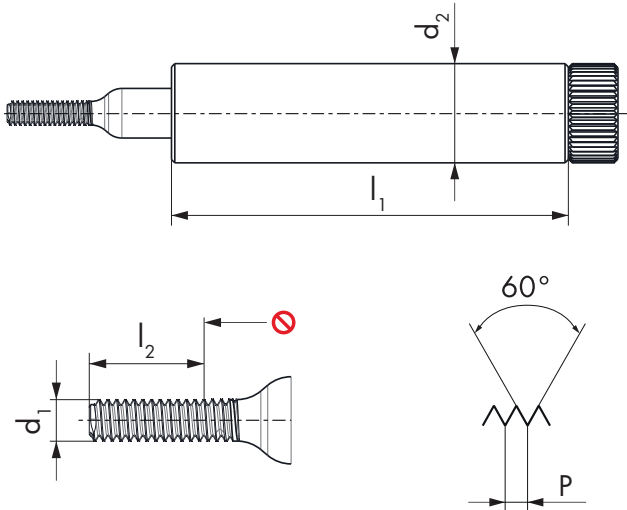

| $\emptyset d_1$ S | P mm | l_1 mm | l_2 GO mm | d_2 mm | ID | ID | ID |
|----------------------|---------|-------------|----------------|-------------|----------|----------|----------|
| 0.3 | 0.08 | 24 | 0.9 | 6 | ● 190733 | ● 193242 | ● 190752 |
| 0.35 | 0.09 | 24 | 1.05 | 6 | ● 190734 | ● 193243 | ● 190753 |
| 0.4 | 0.1 | 24 | 1.2 | 6 | ● 190735 | ● 193244 | ● 190754 |
| 0.5 | 0.125 | 24 | 1.5 | 6 | ● 190736 | ● 193245 | ● 190755 |
| 0.6 | 0.15 | 24 | 1.8 | 6 | ● 190737 | ● 193246 | ● 190756 |
| 0.7 | 0.175 | 24 | 2.1 | 6 | ● 190738 | ● 193247 | ● 190757 |
| 0.8 | 0.2 | 24 | 2.4 | 6 | ● 190739 | ● 193248 | ● 190758 |
| 0.9 | 0.225 | 24 | 2.7 | 6 | ● 190740 | ● 193249 | ● 190759 |
| 1 | 0.25 | 24 | 3 | 6 | ● 190741 | ● 193250 | ● 190760 |
| 1.2 | 0.25 | 24 | 3.6 | 6 | ● 190742 | ● 193251 | ● 190761 |
| 1.4 | 0.3 | 24 | 4.2 | 6 | ● 190743 | ● 193252 | ● 190762 |



All nano thread plug gauges are SCS-certified and the paid certificate is available on request.

nano

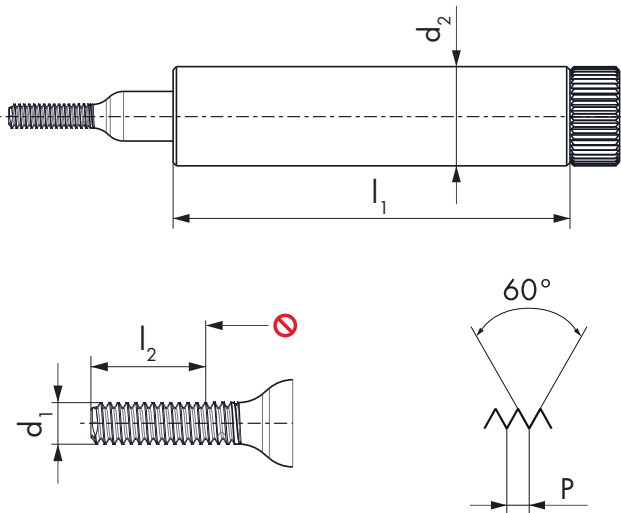

DN01 GO

DN02 NO-GO



| $\emptyset d_1$ S | P mm | l_1 mm | l_2 GO mm | d_2 mm | ID | ID |
|----------------------|---------|-------------|----------------|-------------|----------|----------|
| 0.3 | 0.08 | 24 | 0.9 | 6 | ● 190771 | ● 190790 |
| 0.35 | 0.09 | 24 | 1.05 | 6 | ● 190772 | ● 190791 |
| 0.4 | 0.1 | 24 | 1.2 | 6 | ● 190773 | ● 190792 |
| 0.5 | 0.125 | 24 | 1.5 | 6 | ● 190774 | ● 190793 |
| 0.6 | 0.15 | 24 | 1.8 | 6 | ● 190775 | ● 190794 |
| 0.7 | 0.175 | 24 | 2.1 | 6 | ● 190776 | ● 190795 |
| 0.8 | 0.2 | 24 | 2.4 | 6 | ● 190777 | ● 190796 |
| 0.9 | 0.225 | 24 | 2.7 | 6 | ● 190778 | ● 190797 |
| 1 | 0.25 | 24 | 3 | 6 | ● 190779 | ● 190798 |
| 1.2 | 0.25 | 24 | 3.6 | 6 | ● 190780 | ● 190799 |
| 1.4 | 0.3 | 24 | 4.2 | 6 | ● 190781 | ● 190800 |



All nano thread plug gauges are SCS-certified and the paid certificate is available on request.

nano

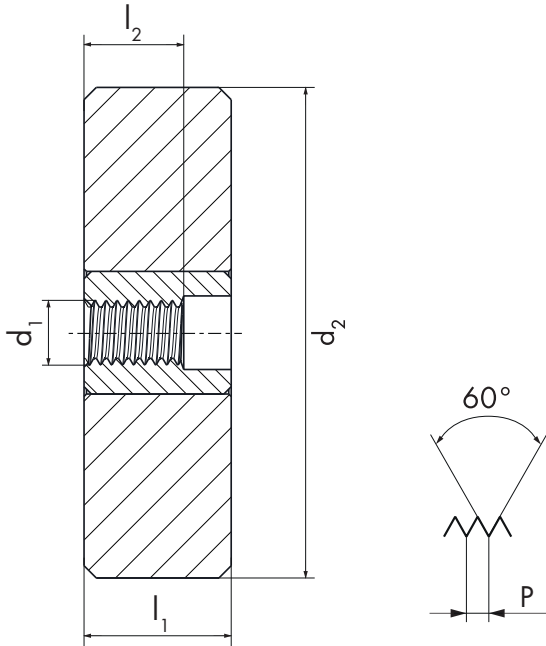

DZ04 GO

DZ14 NO-GO

DZ04 GO

DZ14 NO-GO



| $\emptyset d_1$ S | P mm | l_1 mm | l_2 GO mm | d_2 mm | ID | ID | ID | ID |
|----------------------|---------|-------------|----------------|-------------|----------|----------|----------|----------|
| * 0.3 | 0.08 | 6 | 0.45 | 20 | ● 190809 | ● 190828 | ● 190847 | ● 190866 |
| * 0.35 | 0.09 | 6 | 0.53 | 20 | ● 190810 | ● 190829 | ● 190848 | ● 190867 |
| 0.4 | 0.1 | 6 | 0.6 | 20 | ● 190811 | ● 190830 | ● 190849 | ● 190868 |
| 0.5 | 0.125 | 6 | 0.75 | 20 | ● 190812 | ● 190831 | ● 190850 | ● 190869 |
| 0.6 | 0.15 | 6 | 0.9 | 20 | ● 190813 | ● 190832 | ● 190851 | ● 190870 |
| 0.7 | 0.175 | 6 | 1.05 | 20 | ● 190814 | ● 190833 | ● 190852 | ● 190871 |
| 0.8 | 0.2 | 6 | 1.2 | 20 | ● 190815 | ● 190834 | ● 190853 | ● 190872 |
| 0.9 | 0.225 | 6 | 1.35 | 20 | ● 190816 | ● 190835 | ● 190854 | ● 190873 |
| 1 | 0.25 | 6 | 1.5 | 20 | ● 190817 | ● 190836 | ● 190855 | ● 190874 |
| 1.2 | 0.25 | 6 | 1.8 | 20 | ● 190818 | ● 190837 | ● 190856 | ● 190875 |
| 1.4 | 0.3 | 6 | 2.1 | 20 | ● 190819 | ● 190838 | ● 190857 | ● 190876 |

* In development



All nano ring gauges have a certificate of measurement, established with SCS certified plug check gauges. The paid certificate is available on request.

nano

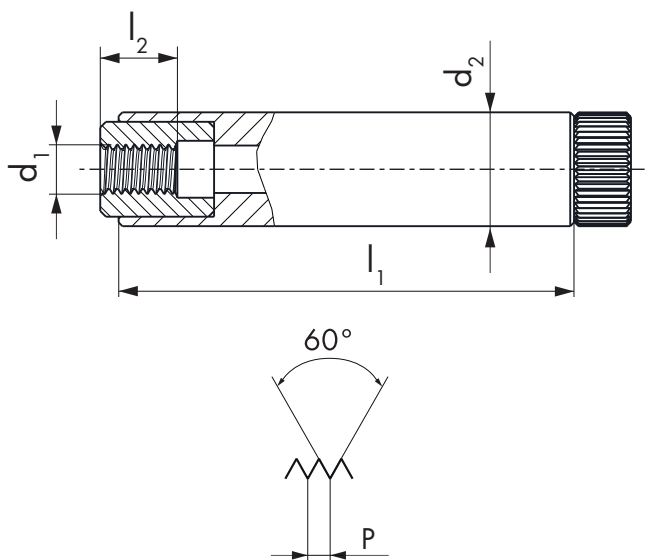

DN04 GO

DN14 NO-GO

DN04 GO

DN14 NO-GO



| $\emptyset d_1$ S | P mm | l_1 mm | l_2 GO mm | d_2 mm | ID | ID | ID | ID |
|----------------------|---------|-------------|----------------|-------------|----------|----------|----------|----------|
| * 0.3 | 0.08 | 24 | 0.45 | 6 | ● 190885 | ● 190904 | ● 190923 | ● 190942 |
| * 0.35 | 0.09 | 24 | 0.53 | 6 | ● 190886 | ● 190905 | ● 190924 | ● 190943 |
| 0.4 | 0.1 | 24 | 0.6 | 6 | ● 190887 | ● 190906 | ● 190925 | ● 190944 |
| 0.5 | 0.125 | 24 | 0.75 | 6 | ● 190888 | ● 190907 | ● 190926 | ● 190945 |
| 0.6 | 0.15 | 24 | 0.9 | 6 | ● 190889 | ● 190908 | ● 190927 | ● 190946 |
| 0.7 | 0.175 | 24 | 1.05 | 6 | ● 190890 | ● 190909 | ● 190928 | ● 190947 |
| 0.8 | 0.2 | 24 | 1.2 | 6 | ● 190891 | ● 190910 | ● 190929 | ● 190948 |
| 0.9 | 0.225 | 24 | 1.35 | 6 | ● 190892 | ● 190911 | ● 190930 | ● 190949 |
| 1 | 0.25 | 24 | 1.5 | 6 | ● 190893 | ● 190912 | ● 190931 | ● 190950 |
| 1.2 | 0.25 | 24 | 1.8 | 6 | ● 190894 | ● 190913 | ● 190932 | ● 190951 |
| 1.4 | 0.3 | 24 | 2.1 | 6 | ● 190895 | ● 190914 | ● 190933 | ● 190952 |

*In development



All nano ring gauges have a certificate of measurement, established with SCS certified plug check gauges. The paid certificate is available on request.

nano

DN01 GO

DN01 GO

DN02 NO-GO

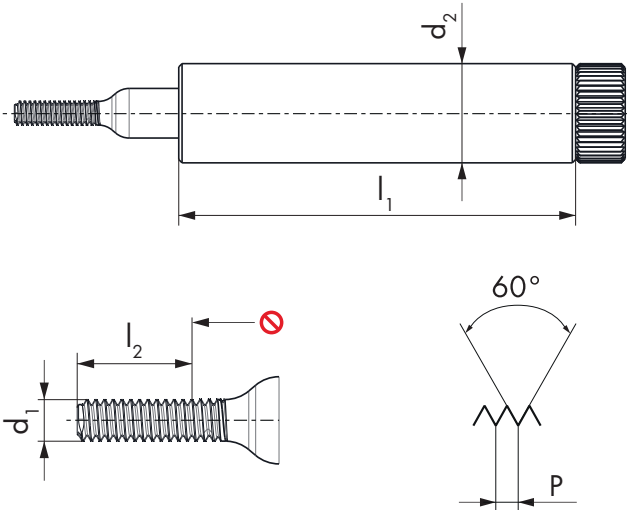

| $\emptyset d_1$ SF | P mm | l_1 mm | l_2 GO mm | d_2 mm | ID | ID | ID |
|-----------------------|---------|-------------|----------------|-------------|----------|----------|----------|
| 1.4 | 0.2 | 24 | 4.2 | 6 | ● 190744 | ● 193256 | ● 190763 |
| 1.6 | 0.2 | 24 | 3 | 6 | ● 190745 | ● 193257 | ● 190764 |
| 1.8 | 0.2 | 24 | 3 | 6 | ● 190746 | ● 193258 | ● 190765 |
| 2 | 0.2 | 24 | 3 | 6 | ● 190747 | ● 193259 | ● 190766 |
| 2.2 | 0.2 | 24 | 3 | 6 | ● 190748 | ● 193260 | ● 190767 |
| 2.2 | 0.25 | 24 | 3 | 6 | ● 190749 | ● 193261 | ● 190768 |
| 2.5 | 0.2 | 24 | 3 | 6 | ● 190750 | ● 193262 | ● 190769 |
| 2.5 | 0.25 | 24 | 3 | 6 | ● 190751 | ● 193263 | ● 190770 |

nano



All nano thread plug gauges are SCS-certified and the paid certificate is available on request.

nano

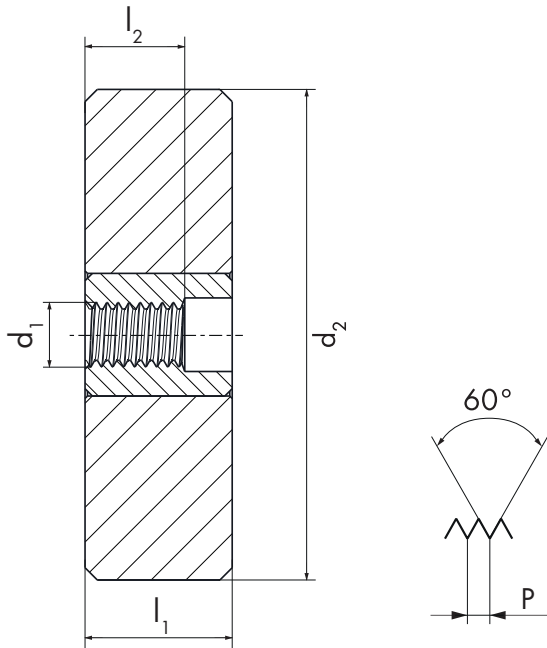

DZ04 GO

DZ14 NO-GO



| $\emptyset d_1$ SF | P mm | l_1 mm | l_2 GO mm | d_2 mm | ID | ID |
|-----------------------|---------|-------------|----------------|-------------|----------|----------|
| 1.4 | 0.2 | 6 | 2.1 | 20 | ● 190820 | ● 190839 |
| 1.6 | 0.2 | 6 | 1.8 | 20 | ● 190821 | ● 190840 |
| 1.8 | 0.2 | 6 | 1.8 | 20 | ● 190822 | ● 190841 |
| 2 | 0.2 | 6 | 1.8 | 20 | ● 190823 | ● 190842 |
| 2.2 | 0.2 | 6 | 1.8 | 20 | ● 190824 | ● 190843 |
| 2.2 | 0.25 | 6 | 2.25 | 20 | ● 190825 | ● 190844 |
| 2.5 | 0.2 | 6 | 1.8 | 20 | ● 190826 | ● 190845 |
| 2.5 | 0.25 | 6 | 2.25 | 20 | ● 190827 | ● 190846 |



All nano ring gauges have a certificate of measurement, established with SCS certified plug check gauges. The paid certificate is available on request.

nano

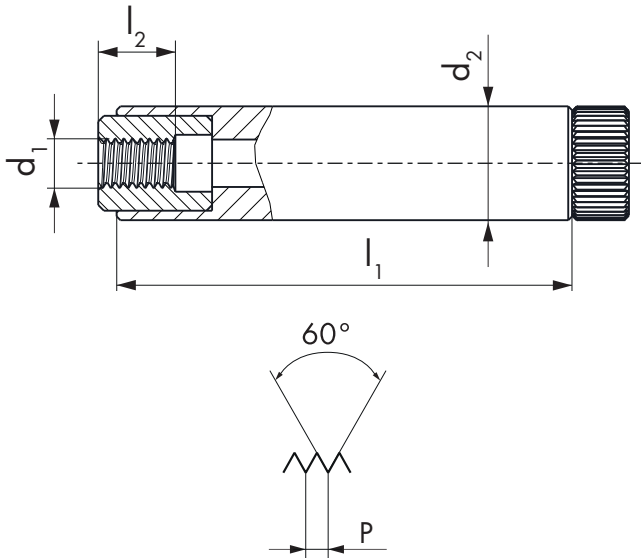

DN04 GO

DN14 NO-GO



| $\emptyset d_1$ SF | P mm | l_1 mm | l_2 GO mm | d_2 mm | ID | ID |
|-----------------------|---------|-------------|----------------|-------------|----------|----------|
| 1.4 | 0.2 | 24 | 2.1 | 6 | ● 190896 | ● 190915 |
| 1.6 | 0.2 | 24 | 1.8 | 6 | ● 190897 | ● 190916 |
| 1.8 | 0.2 | 24 | 1.8 | 6 | ● 190898 | ● 190917 |
| 2 | 0.2 | 24 | 1.8 | 6 | ● 190899 | ● 190918 |
| 2.2 | 0.2 | 24 | 1.8 | 6 | ● 190900 | ● 190919 |
| 2.2 | 0.25 | 24 | 2.25 | 6 | ● 190901 | ● 190920 |
| 2.5 | 0.2 | 24 | 1.8 | 6 | ● 190902 | ● 190921 |
| 2.5 | 0.25 | 24 | 2.28 | 6 | ● 190903 | ● 190922 |



All nano ring gauges have a certificate of measurement, established with SCS certified plug check gauges. The paid certificate is available on request.

nano

DN01 GO

DN02 NO-GO

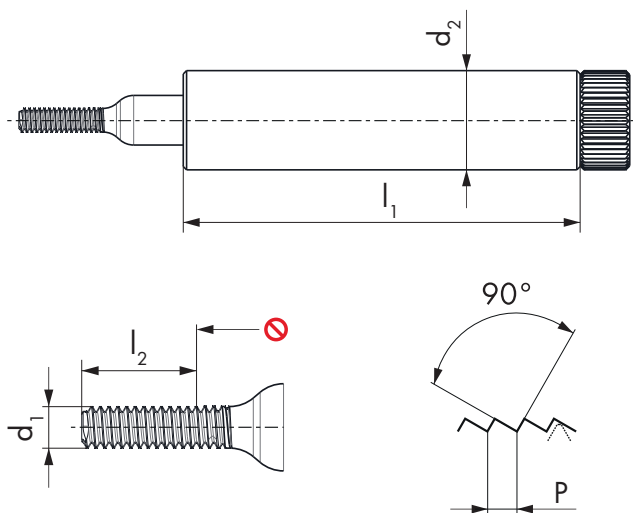

| $\emptyset d_1$ SL | P mm | l_1 mm | l_2 GO mm | d_2 mm | ID | ID |
|-----------------------|---------|-------------|----------------|-------------|----------|----------|
| 0.5 | 0.1 | 24 | 1.5 | 6 | ● 600178 | ● 600186 |
| 0.6 | 0.125 | 24 | 1.8 | 6 | ● 600179 | ● 600187 |
| 0.7 | 0.15 | 24 | 2.1 | 6 | ● 600180 | ● 600188 |
| 0.8 | 0.15 | 24 | 2.4 | 6 | ● 600181 | ● 600189 |
| 0.9 | 0.175 | 24 | 2.7 | 6 | ● 600182 | ● 600190 |
| 1 | 0.2 | 24 | 3 | 6 | ● 600183 | ● 600191 |
| 1.2 | 0.2 | 24 | 3.6 | 6 | ● 600184 | ● 600192 |
| 1.4 | 0.25 | 24 | 4.2 | 6 | ● 600185 | ● 600193 |



All nano thread plug gauges are SCS-certified and the paid certificate is available on request.

nano

RN05-1 GO

RN15-1 GO

RN05-1 GO

RN15-1 GO

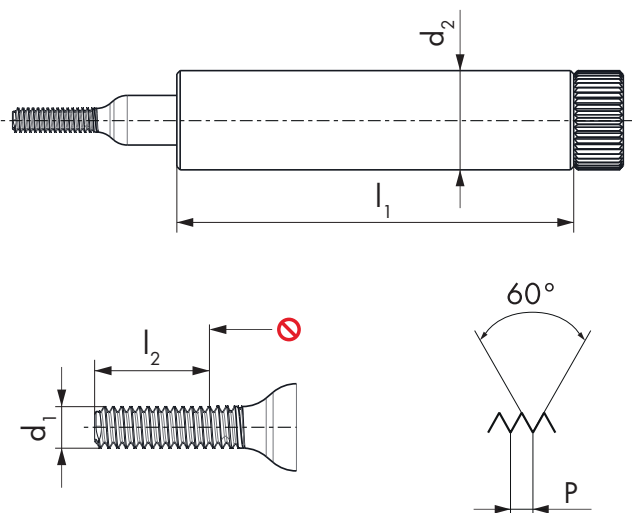

5h

5h

6h

6h

| $\emptyset d_1$ M | P mm | l_1 mm | l_2 GO mm | d_2 mm | ID | ID | ID | ID |
|----------------------|---------|-------------|----------------|-------------|----------|----------|----------|----------|
| 0.3 | 0.08 | 24 | 0.61 | 6 | ● 192884 | ● 192892 | | |
| 0.35 | 0.09 | 24 | 0.71 | 6 | ● 192885 | ● 192893 | | |
| 0.4 | 0.1 | 24 | 0.8 | 6 | ● 192886 | ● 192894 | | |
| 0.5 | 0.125 | 24 | 1 | 6 | ● 192887 | ● 192895 | | |
| 0.6 | 0.15 | 24 | 1.2 | 6 | ● 192888 | ● 192896 | | |
| 0.7 | 0.175 | 24 | 1.4 | 6 | ● 192889 | ● 192897 | | |
| 0.8 | 0.2 | 24 | 1.6 | 6 | ● 192890 | ● 192898 | | |
| 0.9 | 0.225 | 24 | 1.8 | 6 | ● 192891 | ● 192899 | | |
| 1 | 0.25 | 24 | 2 | 6 | | | ● 191499 | ● 191508 |
| 1.2 | 0.25 | 24 | 2.3 | 6 | | | ● 191500 | ● 191509 |
| 1.4 | 0.3 | 24 | 2.7 | 6 | | | ● 191501 | ● 191510 |

6g

6g

| $\emptyset d_1$ M | P mm | l_1 mm | l_2 GO mm | d_2 mm | ID | ID |
|----------------------|---------|-------------|----------------|-------------|----------|----------|
| 1.6 | 0.35 | 24 | 3.1 | 6 | ● 191517 | ● 191535 |
| 1.8 | 0.35 | 24 | 3.4 | 6 | ● 191518 | ● 191536 |
| 2 | 0.4 | 24 | 3.8 | 6 | ● 191519 | ● 191537 |
| 2.3 | 0.4 | 24 | 4.25 | 6 | ● 191520 | ● 191538 |
| 2.5 | 0.45 | 24 | 4.65 | 6 | ● 191521 | ● 191539 |
| 2.6 | 0.45 | 24 | 4.8 | 6 | ● 191522 | ● 191540 |



SCS certificate included.



ISO DIN 14 / ISO DIN 13
DC SWISS NI589 / ISO 1502



nano

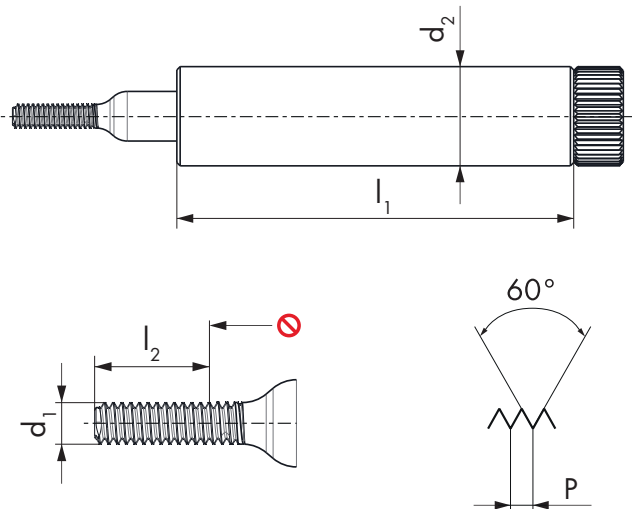

RN05-2
NO-GO

RN15-2
NO-GO

RN05-2
NO-GO

RN15-2
NO-GO



5h

5h

6h

6h

| $\emptyset d_1$ M | P mm | l_1 mm | l_2 GO mm | d_2 mm | ID | ID | ID | ID |
|----------------------|---------|-------------|----------------|-------------|----------|----------|----------|----------|
| 0.3 | 0.08 | 24 | 0.61 | 6 | ● 192900 | ● 192908 | | |
| 0.35 | 0.09 | 24 | 0.71 | 6 | ● 192901 | ● 192909 | | |
| 0.4 | 0.1 | 24 | 0.8 | 6 | ● 192902 | ● 192910 | | |
| 0.5 | 0.125 | 24 | 1 | 6 | ● 192903 | ● 192911 | | |
| 0.6 | 0.15 | 24 | 1.2 | 6 | ● 192904 | ● 192912 | | |
| 0.7 | 0.175 | 24 | 1.4 | 6 | ● 192905 | ● 192913 | | |
| 0.8 | 0.2 | 24 | 1.6 | 6 | ● 192906 | ● 192914 | | |
| 0.9 | 0.225 | 24 | 1.8 | 6 | ● 192907 | ● 192915 | | |
| 1 | 0.25 | 24 | 2 | 6 | | | ● 191502 | ● 191511 |
| 1.2 | 0.25 | 24 | 2.3 | 6 | | | ● 191503 | ● 191512 |
| 1.4 | 0.3 | 24 | 2.7 | 6 | | | ● 191504 | ● 191513 |

6g

6g

| $\emptyset d_1$ M | P mm | l_1 mm | l_2 GO mm | d_2 mm | ID | ID |
|----------------------|---------|-------------|----------------|-------------|----------|----------|
| 1.6 | 0.35 | 24 | 3.1 | 6 | ● 191523 | ● 191541 |
| 1.8 | 0.35 | 24 | 3.4 | 6 | ● 191524 | ● 191542 |
| 2 | 0.4 | 24 | 3.8 | 6 | ● 191525 | ● 191543 |
| 2.3 | 0.4 | 24 | 4.25 | 6 | ● 191526 | ● 191544 |
| 2.5 | 0.45 | 24 | 4.65 | 6 | ● 191527 | ● 191545 |
| 2.6 | 0.45 | 24 | 4.8 | 6 | ● 191528 | ● 191546 |



SCS certificate included.

nano

RN05-3
WEAR

RN15-3
WEAR

RN05-3
WEAR

RN15-3
WEAR

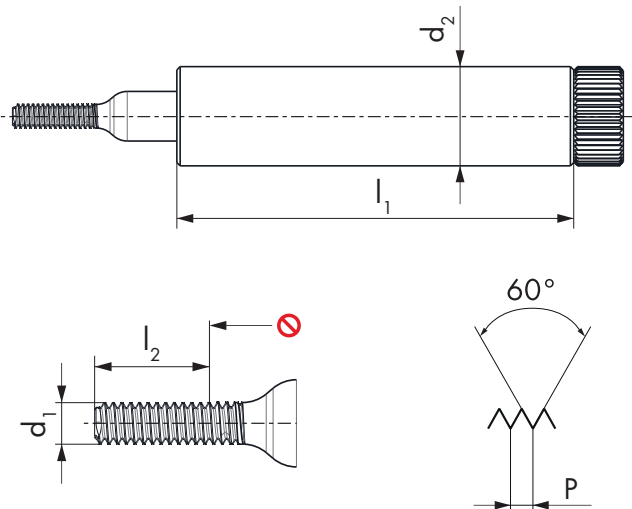

6h

6h

6g

6g

| $\emptyset d_1$ M | P mm | l_1 mm | l_2 GO mm | d_2 mm | ID | ID | ID | ID |
|----------------------|---------|-------------|----------------|-------------|----------|----------|----------|----------|
| 1 | 0.25 | 24 | 2 | 6 | ● 191505 | ● 191514 | | |
| 1.2 | 0.25 | 24 | 2.3 | 6 | ● 191506 | ● 191515 | | |
| 1.4 | 0.3 | 24 | 2.7 | 6 | ● 191507 | ● 191516 | | |
| 1.6 | 0.35 | 24 | 3.1 | 6 | | | ● 191529 | ● 191547 |
| 1.8 | 0.35 | 24 | 3.4 | 6 | | | ● 191530 | ● 191548 |
| 2 | 0.4 | 24 | 3.8 | 6 | | | ● 191531 | ● 191549 |
| 2.3 | 0.4 | 24 | 4.25 | 6 | | | ● 191532 | ● 191550 |
| 2.5 | 0.45 | 24 | 4.65 | 6 | | | ● 191533 | ● 191551 |
| 2.6 | 0.45 | 24 | 4.8 | 6 | | | ● 191534 | ● 191552 |



SCS certificate included.

nano

RN05-1 GO

RN15-1 GO

RN05-1 GO

RN15-1 GO

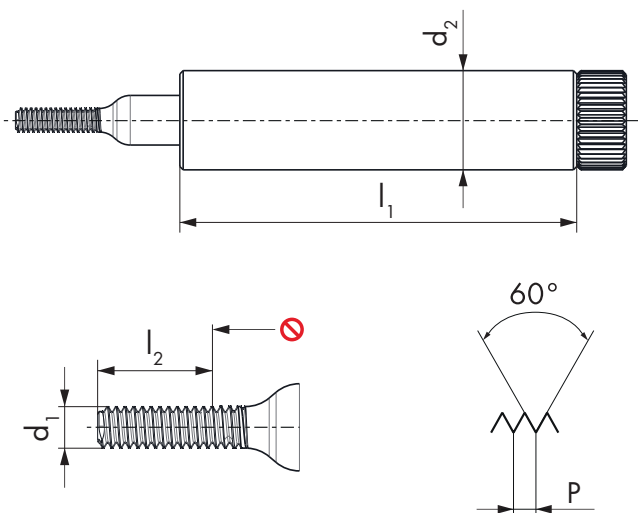

4h

4h

6h

6h

| $\emptyset d_1$ MF | P mm | l_1 mm | l_2 GO mm | d_2 mm | ID | ID | ID | ID |
|-----------------------|---------|-------------|----------------|-------------|----------|----------|----------|----------|
| 1.4 | 0.2 | 24 | 2.5 | 6 | ● 191256 | ● 191298 | ● 192932 | ● 192945 |
| 1.6 | 0.2 | 24 | 2.2 | 6 | ● 195874 | ● 195876 | ● 192933 | ● 192946 |
| 1.8 | 0.2 | 24 | 2.2 | 6 | ● 197711 | ● 197712 | ● 192934 | ● 192947 |
| 2 | 0.2 | 24 | 2.2 | 6 | ● 197724 | ● 197725 | ● 192935 | ● 192948 |
| 2 | 0.25 | 24 | 2.75 | 6 | ● 197726 | ● 197727 | ● 192936 | ● 192949 |
| 2.2 | 0.2 | 24 | 2.2 | 6 | ● 197713 | ● 197714 | ● 192937 | ● 192950 |
| 2.2 | 0.25 | 24 | 2.75 | 6 | ● 197715 | ● 197716 | ● 192938 | ● 192951 |
| 2.3 | 0.2 | 24 | 2.2 | 6 | ● 197717 | ● 197718 | ● 192939 | ● 192952 |
| 2.3 | 0.25 | 24 | 2.75 | 6 | ● 197719 | ● 197720 | ● 192940 | ● 192953 |
| 2.5 | 0.2 | 24 | 2.2 | 6 | ● 197721 | ● 197722 | ● 192941 | ● 192954 |
| 2.5 | 0.25 | 24 | 2.75 | 6 | ● 190683 | ● 197723 | ● 192942 | ● 192955 |
| | | | | | | | 6g | 6g |
| $\emptyset d_1$ MF | P mm | l_1 mm | l_2 GO mm | d_2 mm | ID | ID | | |
| 2.5 | 0.35 | 24 | 4.45 | 6 | ● 192943 | ● 192956 | | |
| 2.6 | 0.35 | 24 | 4.6 | 6 | ● 192944 | ● 192957 | | |



SCS certificate included.

nano

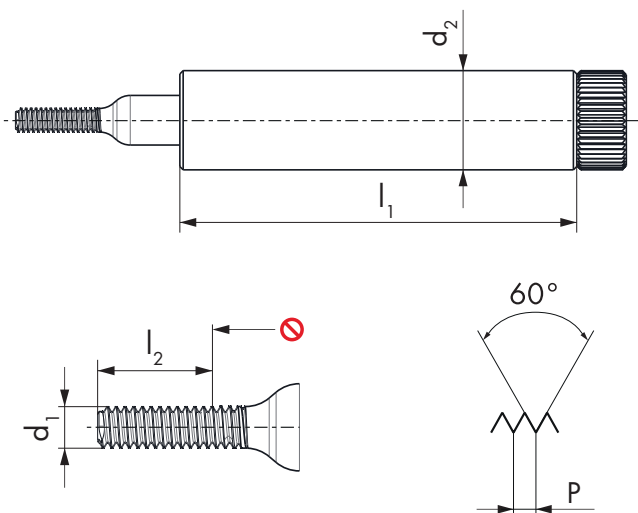

**RN05-2
NO-GO**

**RN15-2
NO-GO**

**RN05-2
NO-GO**

**RN15-2
NO-GO**



4h

4h

6h

6h

| $\emptyset d_1$ MF | P mm | l_1 mm | l_2 GO mm | d_2 mm | ID | ID | ID | ID |
|-----------------------|---------|-------------|----------------|-------------|----------|----------|-----------|-----------|
| 1.4 | 0.2 | 24 | 2.5 | 6 | ● 191270 | ● 197728 | ● 192958 | ● 192971 |
| 1.6 | 0.2 | 24 | 1.6 | 6 | ● 195875 | ● 195877 | ● 192959 | ● 192972 |
| 1.8 | 0.2 | 24 | 1.6 | 6 | ● 197729 | ● 197730 | ● 192960 | ● 192973 |
| 2 | 0.2 | 24 | 1.6 | 6 | ● 199060 | ● 199061 | ● 192961 | ● 192974 |
| 2 | 0.25 | 24 | 2 | 6 | ● 199062 | ● 199063 | ● 192962 | ● 192975 |
| 2.2 | 0.2 | 24 | 1.6 | 6 | ● 197731 | ● 197732 | ● 192963 | ● 192976 |
| 2.2 | 0.25 | 24 | 2 | 6 | ● 197733 | ● 199364 | ● 192964 | ● 192977 |
| 2.3 | 0.2 | 24 | 1.6 | 6 | ● 199053 | ● 199054 | ● 192965 | ● 192978 |
| 2.3 | 0.25 | 24 | 2 | 6 | ● 199055 | ● 199056 | ● 192966 | ● 192979 |
| 2.5 | 0.2 | 24 | 1.6 | 6 | ● 199057 | ● 199058 | ● 192967 | ● 192980 |
| 2.5 | 0.25 | 24 | 2 | 6 | ● 190686 | ● 199059 | ● 192968 | ● 192981 |
| | | | | | | | 6g | 6g |
| $\emptyset d_1$ MF | P mm | l_1 mm | l_2 GO mm | d_2 mm | ID | | ID | ID |
| 2.5 | 0.35 | 24 | 4.45 | 6 | ● 192969 | | ● 192982 | |
| 2.6 | 0.35 | 24 | 4.6 | 6 | ● 192970 | | ● 192983 | |



SCS certificate included.

nano

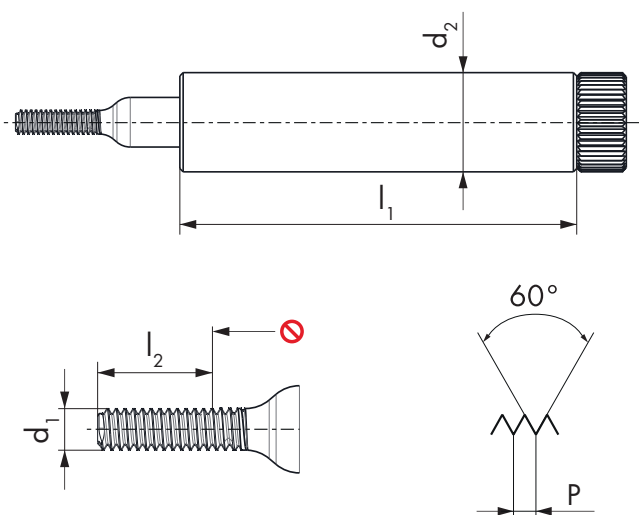

RN05-3 WEAR **RN15-3 WEAR** **RN05-3 WEAR** **RN15-3 WEAR**



4h **4h** **6h** **6h**

| $\emptyset d_1$ MF | P mm | l_1 mm | l_2 G0 mm | d_2 mm | ID | ID | ID | ID |
|-----------------------|---------|-------------|----------------|-------------|----------|----------|----------|----------|
| 1.4 | 0.2 | 24 | 2.5 | 6 | ● 191284 | ● 191326 | ● 192984 | ● 192997 |
| 1.6 | 0.2 | 24 | 1.6 | 6 | ● 199064 | ● 199065 | ● 192985 | ● 192998 |
| 1.8 | 0.2 | 24 | 1.6 | 6 | ● 199066 | ● 199067 | ● 192986 | ● 192999 |
| 2 | 0.2 | 24 | 1.6 | 6 | ● 199360 | ● 199361 | ● 192987 | ● 193000 |
| 2 | 0.25 | 24 | 2 | 6 | ● 199362 | ● 199363 | ● 192988 | ● 193001 |
| 2.2 | 0.2 | 24 | 1.6 | 6 | ● 199068 | ● 199069 | ● 192989 | ● 193002 |
| 2.2 | 0.25 | 24 | 2 | 6 | ● 199070 | ● 199071 | ● 192990 | ● 193003 |
| 2.3 | 0.2 | 24 | 1.6 | 6 | ● 199072 | ● 199073 | ● 192991 | ● 193004 |
| 2.3 | 0.25 | 24 | 2 | 6 | ● 199074 | ● 199075 | ● 192992 | ● 193005 |
| 2.5 | 0.2 | 24 | 1.6 | 6 | ● 199076 | ● 199077 | ● 192993 | ● 193006 |
| 2.5 | 0.25 | 24 | 2 | 6 | ● 199358 | ● 199359 | ● 192994 | ● 193007 |

6g **6g**

| $\emptyset d_1$ MF | P mm | l_1 mm | l_2 G0 mm | d_2 mm | ID | ID |
|-----------------------|---------|-------------|----------------|-------------|----------|----------|
| 2.5 | 0.35 | 24 | 4.45 | 6 | ● 192995 | ● 193008 |
| 2.6 | 0.35 | 24 | 4.6 | 6 | ● 192996 | ● 193009 |



SCS certificate included.

UNC, UNF ASME B1.1 DC SWISS NI582

VHM
CAR

nano

RN05-1 GO

RN15-1 GO

RN05-1 GO

RN15-1 GO

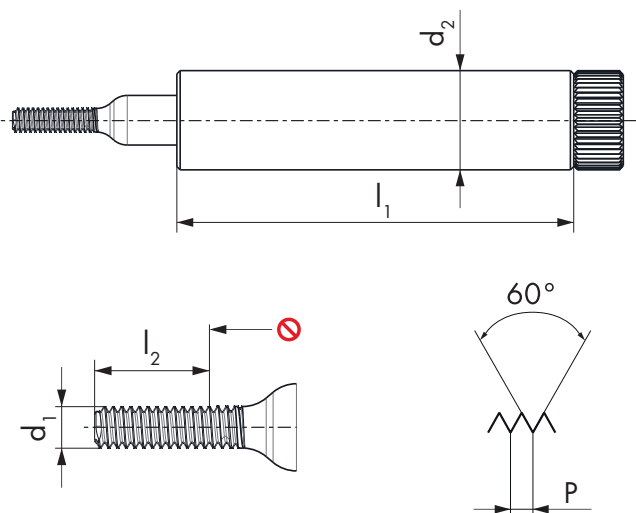

2A

2A

3A

3A

| $\emptyset d_1$ UNC | P TPI | $\emptyset d_1$ mm | l_1 mm | l_2 GO mm | d_2 mm | ID | ID | ID | ID |
|------------------------|----------|-----------------------|-------------|----------------|-------------|----------|----------|----------|----------|
| 1 | 64 | 1.854 | 24 | 3.58 | 6 | ● 191613 | ● 191619 | ● 191625 | ● 191631 |
| 2 | 56 | 2.184 | 24 | 4.18 | 6 | ● 191614 | ● 191620 | ● 191626 | ● 191632 |
| 3 | 48 | 2.515 | 24 | 4.83 | 6 | ● 191615 | ● 191621 | ● 191627 | ● 191633 |
| | | | | | | | | | |
| $\emptyset d_1$ UNF | P TPI | $\emptyset d_1$ mm | l_1 mm | l_2 GO mm | d_2 mm | ID | ID | ID | ID |
| 0 | 80 | 1.524 | 24 | 2.92 | 6 | ● 191685 | ● 191693 | ● 191701 | ● 191709 |
| 1 | 72 | 1.854 | 24 | 3.49 | 6 | ● 191686 | ● 191694 | ● 191702 | ● 191710 |
| 2 | 64 | 2.184 | 24 | 4.07 | 6 | ● 191687 | ● 191695 | ● 191703 | ● 191711 |
| 3 | 56 | 2.515 | 24 | 4.68 | 6 | ● 191688 | ● 191696 | ● 191704 | ● 191712 |



SCS certificate included.



UNC, UNF ASME B1.1 DC SWISS NI582

VHM
CAR

nano

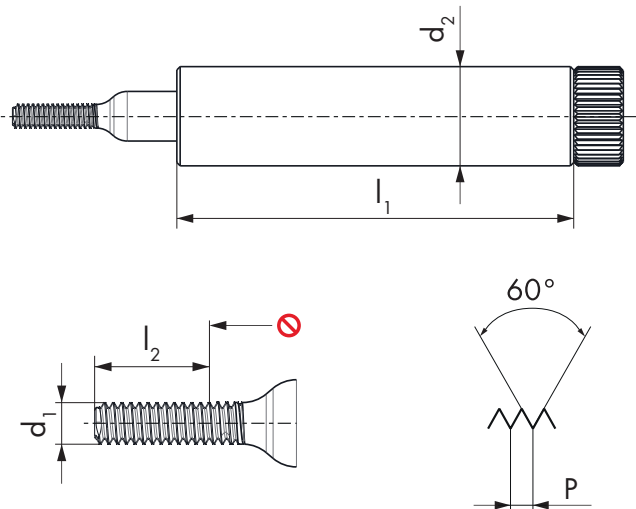

RN05-2
NO-GO

RN15-2
NO-GO

RN05-2
NO-GO

RN15-2
NO-GO



2A

2A

3A

3A

| $\emptyset d_1$ UNC | P TPI | $\emptyset d_1$ mm | l_1 mm | l_2 GO mm | d_2 mm | ID | ID | ID | ID |
|------------------------|----------|-----------------------|-------------|----------------|-------------|----------|----------|----------|----------|
| 1 | 64 | 1.854 | 24 | 3.58 | 6 | ● 191616 | ● 191622 | ● 191628 | ● 191634 |
| 2 | 56 | 2.184 | 24 | 4.18 | 6 | ● 191617 | ● 191623 | ● 191629 | ● 191635 |
| 3 | 48 | 2.515 | 24 | 4.83 | 6 | ● 191618 | ● 191624 | ● 191630 | ● 191636 |
| | | | | | | | | | |
| $\emptyset d_1$ UNF | P TPI | $\emptyset d_1$ mm | l_1 mm | l_2 GO mm | d_2 mm | ID | ID | ID | ID |
| 0 | 80 | 1.524 | 24 | 2.92 | 6 | ● 191689 | ● 191697 | ● 191705 | ● 191713 |
| 1 | 72 | 1.854 | 24 | 3.49 | 6 | ● 191690 | ● 191698 | ● 191706 | ● 191714 |
| 2 | 64 | 2.184 | 24 | 4.07 | 6 | ● 191691 | ● 191699 | ● 191707 | ● 191715 |
| 3 | 56 | 2.515 | 24 | 4.68 | 6 | ● 191692 | ● 191700 | ● 191708 | ● 191716 |



SCS certificate included.

nano

RN05-1 GO

RN15-1 GO

RN05-1 GO

RN15-1 GO

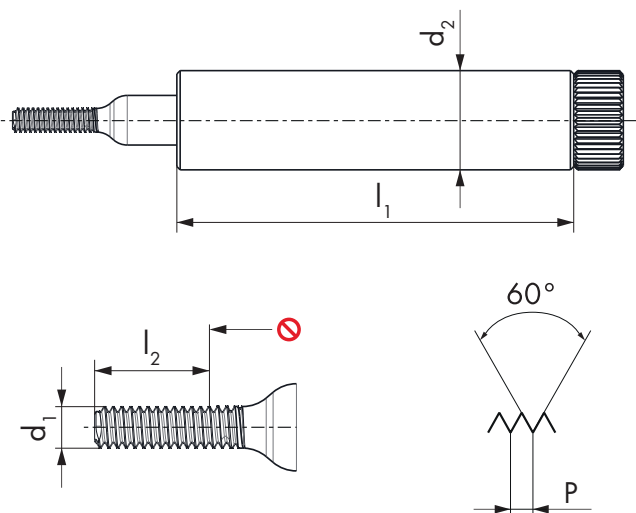

| $\emptyset d_1$ S | P mm | l_1 mm | l_2 GO mm | d_2 mm | ID | ID | ID | ID |
|----------------------|---------|-------------|----------------|-------------|----------|----------|----------|----------|
| 0.3 | 0.08 | 24 | 0.61 | 6 | ● 190961 | ● 190999 | ● 191037 | ● 191075 |
| 0.35 | 0.09 | 24 | 0.71 | 6 | ● 190962 | ● 191000 | ● 191038 | ● 191076 |
| 0.4 | 0.1 | 24 | 0.8 | 6 | ● 190963 | ● 191001 | ● 191039 | ● 191077 |
| 0.5 | 0.125 | 24 | 1 | 6 | ● 190964 | ● 191002 | ● 191040 | ● 191078 |
| 0.6 | 0.15 | 24 | 1.2 | 6 | ● 190965 | ● 191003 | ● 191041 | ● 191079 |
| 0.7 | 0.175 | 24 | 1.4 | 6 | ● 190966 | ● 191004 | ● 191042 | ● 191080 |
| 0.8 | 0.2 | 24 | 1.6 | 6 | ● 190967 | ● 191005 | ● 191043 | ● 191081 |
| 0.9 | 0.225 | 24 | 1.8 | 6 | ● 190968 | ● 191006 | ● 191044 | ● 191082 |
| 1 | 0.25 | 24 | 2 | 6 | ● 190969 | ● 191007 | ● 191045 | ● 191083 |
| 1.2 | 0.25 | 24 | 2.3 | 6 | ● 190970 | ● 191008 | ● 191046 | ● 191084 |
| 1.4 | 0.3 | 24 | 2.7 | 6 | ● 190971 | ● 191009 | ● 191047 | ● 191085 |



SCS certificate included.

nano

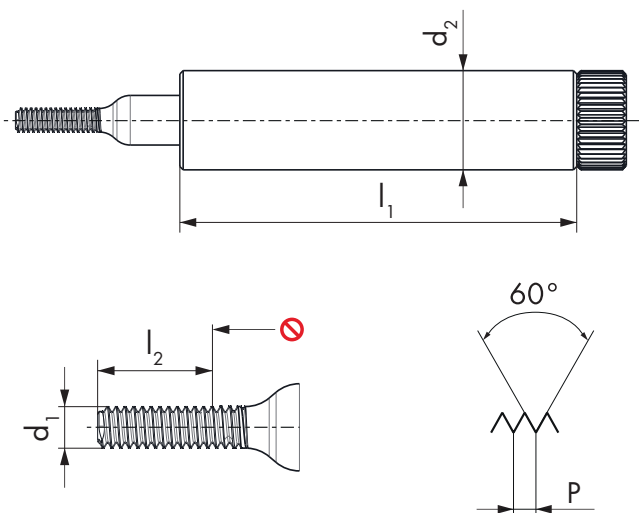

**RN05-2
NO-GO**

**RN15-2
NO-GO**

**RN05-2
NO-GO**

**RN15-2
NO-GO**



| $\emptyset d_1$ S | P mm | l_1 mm | l_2 GO mm | d_2 mm | ID | ID | ID | ID |
|----------------------|---------|-------------|----------------|-------------|----------|----------|----------|----------|
| 0.3 | 0.08 | 24 | 0.61 | 6 | ● 190980 | ● 191018 | ● 191056 | ● 191094 |
| 0.35 | 0.09 | 24 | 0.71 | 6 | ● 190981 | ● 191019 | ● 191057 | ● 191095 |
| 0.4 | 0.1 | 24 | 0.8 | 6 | ● 190982 | ● 191020 | ● 191058 | ● 191096 |
| 0.5 | 0.125 | 24 | 1 | 6 | ● 190983 | ● 191021 | ● 191059 | ● 191097 |
| 0.6 | 0.15 | 24 | 1.2 | 6 | ● 190984 | ● 191022 | ● 191060 | ● 191098 |
| 0.7 | 0.175 | 24 | 1.4 | 6 | ● 190985 | ● 191023 | ● 191061 | ● 191099 |
| 0.8 | 0.2 | 24 | 1.6 | 6 | ● 190986 | ● 191024 | ● 191062 | ● 191100 |
| 0.9 | 0.225 | 24 | 1.8 | 6 | ● 190987 | ● 191025 | ● 191063 | ● 191101 |
| 1 | 0.25 | 24 | 2 | 6 | ● 190988 | ● 191026 | ● 191064 | ● 191102 |
| 1.2 | 0.25 | 24 | 2.3 | 6 | ● 190989 | ● 191027 | ● 191065 | ● 191103 |
| 1.4 | 0.3 | 24 | 2.7 | 6 | ● 190990 | ● 191028 | ● 191066 | ● 191104 |



SCS certificate included.

nano

RN05-1 GO

RN15-1 GO

RN05-1 GO

RN15-1 GO

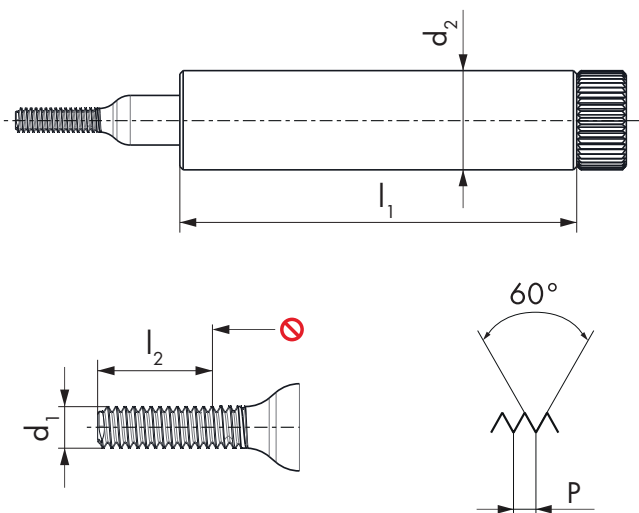

| $\emptyset d_1$ SF | P mm | l_1 mm | l_2 GO mm | d_2 mm | ID | ID | ID | ID |
|-----------------------|---------|-------------|----------------|-------------|----------|----------|----------|----------|
| 1.4 | 0.2 | 24 | 2.5 | 6 | ● 190972 | ● 191010 | ● 191048 | ● 191086 |
| 1.6 | 0.2 | 24 | 2.2 | 6 | ● 190973 | ● 191011 | ● 191049 | ● 191087 |
| 1.8 | 0.2 | 24 | 2.2 | 6 | ● 190974 | ● 191012 | ● 191050 | ● 191088 |
| 2 | 0.2 | 24 | 2.2 | 6 | ● 190975 | ● 191013 | ● 191051 | ● 191089 |
| 2.2 | 0.2 | 24 | 2.2 | 6 | ● 190976 | ● 191014 | ● 191052 | ● 191090 |
| 2.2 | 0.25 | 24 | 2.75 | 6 | ● 190977 | ● 191015 | ● 191053 | ● 191091 |
| 2.5 | 0.2 | 24 | 2.2 | 6 | ● 190978 | ● 191016 | ● 191054 | ● 191092 |
| 2.5 | 0.25 | 24 | 2.75 | 6 | ● 190979 | ● 191017 | ● 191055 | ● 191093 |



SCS certificate included.

nano

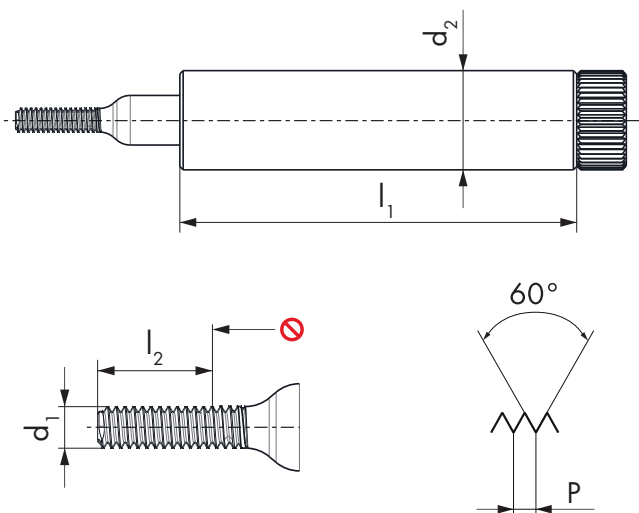

RN05-2
NO-GO

RN15-2
NO-GO

RN05-2
NO-GO

RN15-2
NO-GO



| $\emptyset d_1$ SF | P mm | l_1 mm | l_2 GO mm | d_2 mm | ID | ID | ID | ID |
|-----------------------|---------|-------------|----------------|-------------|----------|----------|----------|----------|
| 1.4 | 0.2 | 24 | 2.5 | 6 | ● 190991 | ● 191029 | ● 191067 | ● 191105 |
| 1.6 | 0.2 | 24 | 1.6 | 6 | ● 190992 | ● 191030 | ● 191068 | ● 191106 |
| 1.8 | 0.2 | 24 | 1.6 | 6 | ● 190993 | ● 191031 | ● 191069 | ● 191107 |
| 2 | 0.2 | 24 | 1.6 | 6 | ● 190994 | ● 191032 | ● 191070 | ● 191108 |
| 2.2 | 0.2 | 24 | 1.6 | 6 | ● 190995 | ● 191033 | ● 191071 | ● 191109 |
| 2.2 | 0.25 | 24 | 2 | 6 | ● 190996 | ● 191034 | ● 191072 | ● 191110 |
| 2.5 | 0.2 | 24 | 1.6 | 6 | ● 190997 | ● 191035 | ● 191073 | ● 191111 |
| 2.5 | 0.25 | 24 | 2 | 6 | ● 190998 | ● 191036 | ● 191074 | ● 191112 |



SCS certificate included.

nano

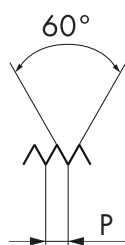
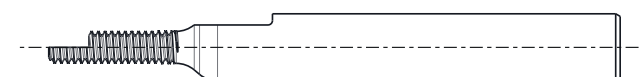
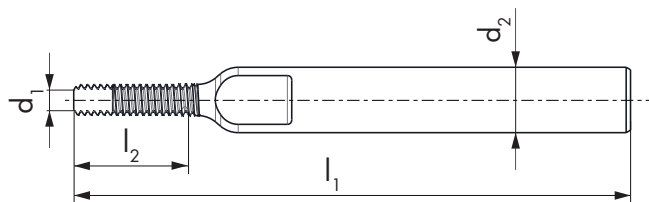

EN00



NIHS

| $\varnothing d_1$ S | P mm | l_1 mm | l_2 GO mm | d_2 mm | ID |
|------------------------|---------|-------------|----------------|-------------|----------|
| 0.3 | 0.08 | 39 | 1.28 | 3 | ● 192747 |
| 0.35 | 0.09 | 39 | 1.44 | 3 | ● 192748 |
| 0.4 | 0.1 | 39 | 1.6 | 3 | ● 192749 |
| 0.5 | 0.125 | 39 | 2 | 3 | ● 192750 |
| 0.6 | 0.15 | 39 | 2.4 | 3 | ● 192751 |
| 0.7 | 0.175 | 39 | 2.8 | 3 | ● 192752 |
| 0.8 | 0.2 | 39 | 3.2 | 3 | ● 192753 |
| 0.9 | 0.225 | 39 | 3.6 | 3 | ● 192754 |
| 1 | 0.25 | 39 | 4 | 3 | ● 192755 |
| 1.2 | 0.25 | 39 | 4 | 3 | ● 192756 |
| 1.4 | 0.3 | 39 | 4.8 | 3 | ● 192757 |

Der DC SWISS Kalibrier-Gewindelehndorn wird zur Eichung von Messmaschinen verwendet. Die Kalibrierlehren aus unserem Katalog, oder nach Ihren spezifischen Anforderungen gefertigt, werden mit einem SCS-Messzertifikat geliefert. Dieses bestätigt, dass der Kontrollprozess während der Herstellung gewissenhaft gemäß ISO 17025 erfolgt ist. Es bescheinigt die Qualität der messtechnischen Ausrüstung der DC NANO TOOLS SA (SCS 0143), Kompetenzzentrum und Mitglied der DC-Gruppe.

The DC SWISS calibration thread plug gauge is used for the calibration of measuring machines. The calibration gauges from our catalogue, or made to your specific requirements, are delivered with a SCS measurement certificate. This confirms that the control process during production has been conscientiously followed to ISO 17025. It attests to the quality of the metrological equipment of DC NANO TOOLS SA (SCS 0143), centre of competence and member of the DC Group.



SCS certificate included.